

**LEGEND**

- ⊕ EX. ELECTRICAL HAND HOLE
- ⊕ EX. ELECTRICAL PEDESTAL
- ⊕ EX. TELEPHONE PEDESTAL
- ⊕ EX. TREE
- ⊕ EX. WATER HYDRANT
- ⊕ EX. WATER VALVE
- — — — — EX. PROPERTY LINE
- — — — — EX. EASEMENT
- X — — — — — EX. FENCE LINE
- ⌒ — — — — — EX. TREE LINE
- - - - - EX. CONTOUR (INDEX)
- - - - - EX. CONTOUR (INTER)
- ⋯ — — — — — EX. ABANDONED UTILITY
- E — — — — — EX. ELECTRIC
- FO — — — — — EX. FIBER OPTIC
- G — — — — — EX. NATURAL GAS
- OH — — — — — EX. OVERHEAD LINE
- SN — — — — — EX. SANITARY SEWER
- ST — — — — — EX. STORM SEWER
- TV — — — — — EX. CABLE TV
- T — — — — — EX. UNDERGROUND TELEPHONE
- W — — — — — EX. WATER LINE
- ▨ EX. GRAVEL
- ▩ EX. CONCRETE

# McPIKE PARK BUILDING DEMOLITION AND SITE RESTORATION

McPIKE PARK  
202-212 S. BALDWIN ST.

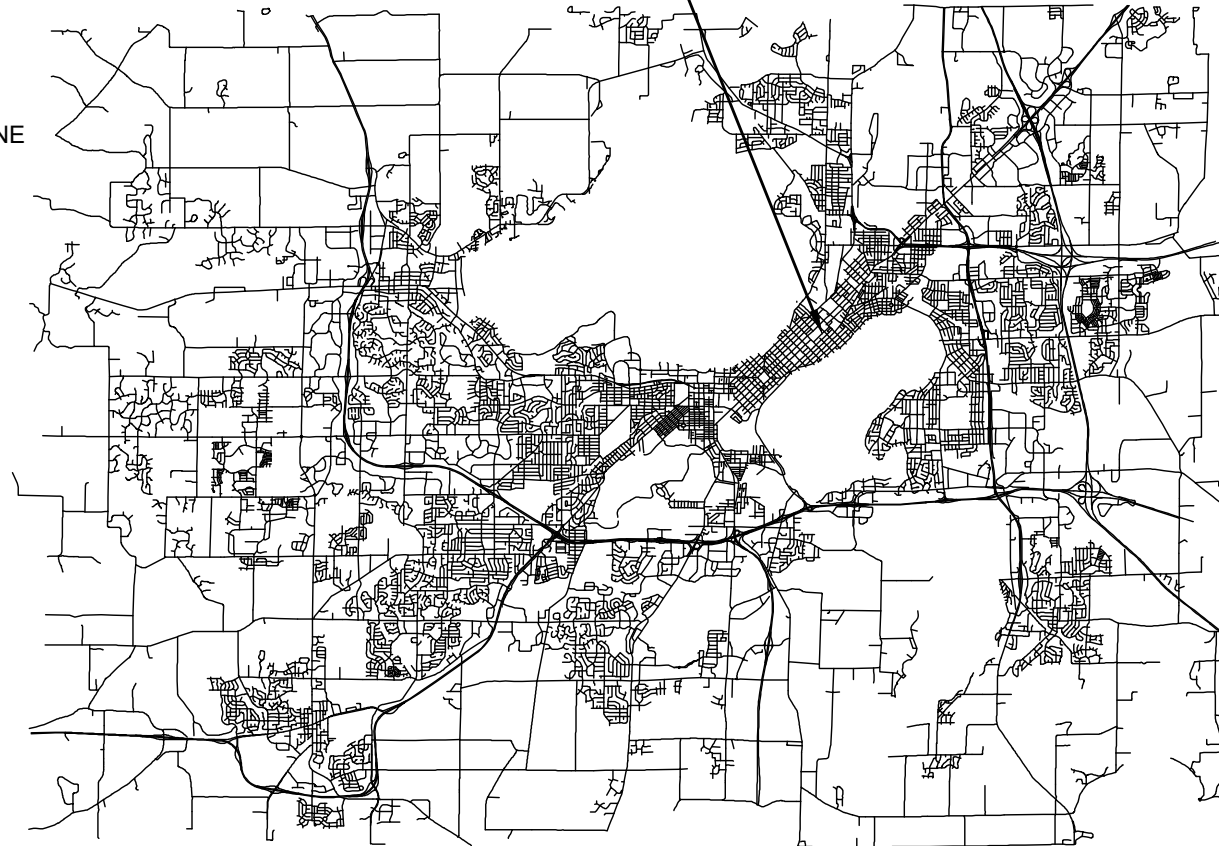

## SHEET SCHEDULE

- 1.0 PROJECT LOCATION
- 1.1 SHEET TILING
- 1.2 EXISTING SITE CONDITIONS - AREA 1
- 1.3 EXISTING SITE CONDITIONS - AREA 2
- 2.1 DEMOLITION AND SITE PROTECTION - AREA 1
- 2.2 DEMOLITION AND SITE PROTECTION - AREA 2
- 2.3 DEMOLITION AND SITE PROTECTION - BALDWIN STREET
- 3.1 SITE GRADING - AREA 1
- 3.2 SITE GRADING - AREA 2
- 4.1 SITE RESTORATION - AREA 1
- 4.2 SITE RESTORATION - AREA 2
- 4.3 SITE RESTORATION - BALDWIN STREET
- 5.1 BUILDING PHOTOS - 202-208 S. BALDWIN EXTERIOR
- 5.2 BUILDING PHOTOS - 202-208 S. BALDWIN INTERIOR
- 5.3 BUILDING PHOTOS - 210 S. BALDWIN EXTERIOR
- 5.4 BUILDING PHOTOS - 210 S. BALDWIN INTERIOR
- 5.5 BUILDING PHOTOS - 212 S. BALDWIN EXTERIOR
- 5.6 BUILDING PHOTOS - 212 S. BALDWIN INTERIOR
- 6.1 EARTHWORK COMPUTATIONS

City of Madison  
Department of Public Works  
**PARKS DIVISION**  
330 E. Lakeside St.  
Madison, WI 53715



PROJECT:  
*McPIKE PARK  
BUILDING  
DEMOLITION AND  
SITE RESTORATION*

*202 - 212 S.  
BALDWIN ST.  
MADISON, WI 53703*

Although every effort has been made in preparing these plans and checking them for accuracy, the contractor and subcontractors must check all details and dimensions of their trade and be responsible for the same.

ITEM	DATE
BID RELEASE DATE	2024-07-25

PUBLIC WORKS PROJECT #:  
**9174**

SHEET TITLE:  
*COVER SHEET*

SHEET NUMBER:



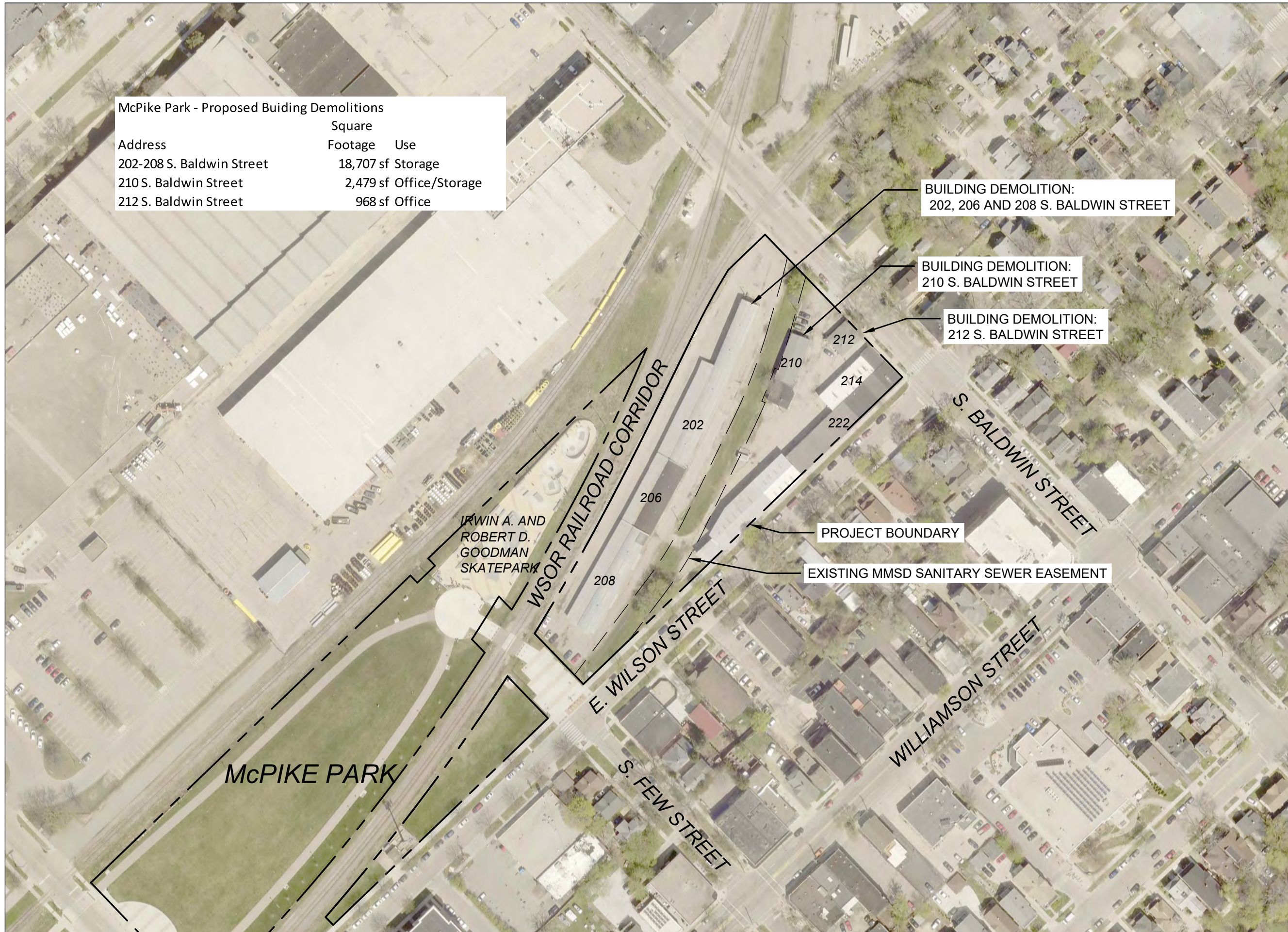

McPike Park - Proposed Buiding Demolitions		
Address	Square Footage	Use
202-208 S. Baldwin Street	18,707 sf	Storage
210 S. Baldwin Street	2,479 sf	Office/Storage
212 S. Baldwin Street	968 sf	Office

BUILDING DEMOLITION:  
202, 206 AND 208 S. BALDWIN STREET

BUILDING DEMOLITION:  
210 S. BALDWIN STREET

BUILDING DEMOLITION:  
212 S. BALDWIN STREET

PROJECT BOUNDARY

EXISTING MMSD SANITARY SEWER EASEMENT

City of Madison  
Department of Public Works  
**PARKS DIVISION**  
330 E. Lakeside Street  
Madison, WI 53715

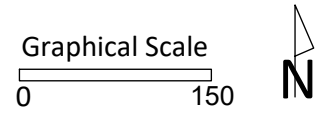

PROJECT:  
*McPIKE PARK  
BUILDING  
DEMOLITION AND  
SITE RESTORATION*

PROJECT ADDRESS:  
*202-212 S. BALDWIN ST.  
MADISON, WI 53703*

Although every effort has been made in preparing these plans and checking them for accuracy, the contractor and subcontractors must check all details and dimensions of their trade and be responsible for the same.

ITEM	DATE
BID RELEASE DATE	07-25-24

PUBLIC WORKS PROJECT #:  
*9174*

SHEET TITLE:  
*PROJECT LOCATON*

SHEET NUMBER:  
**1.0**



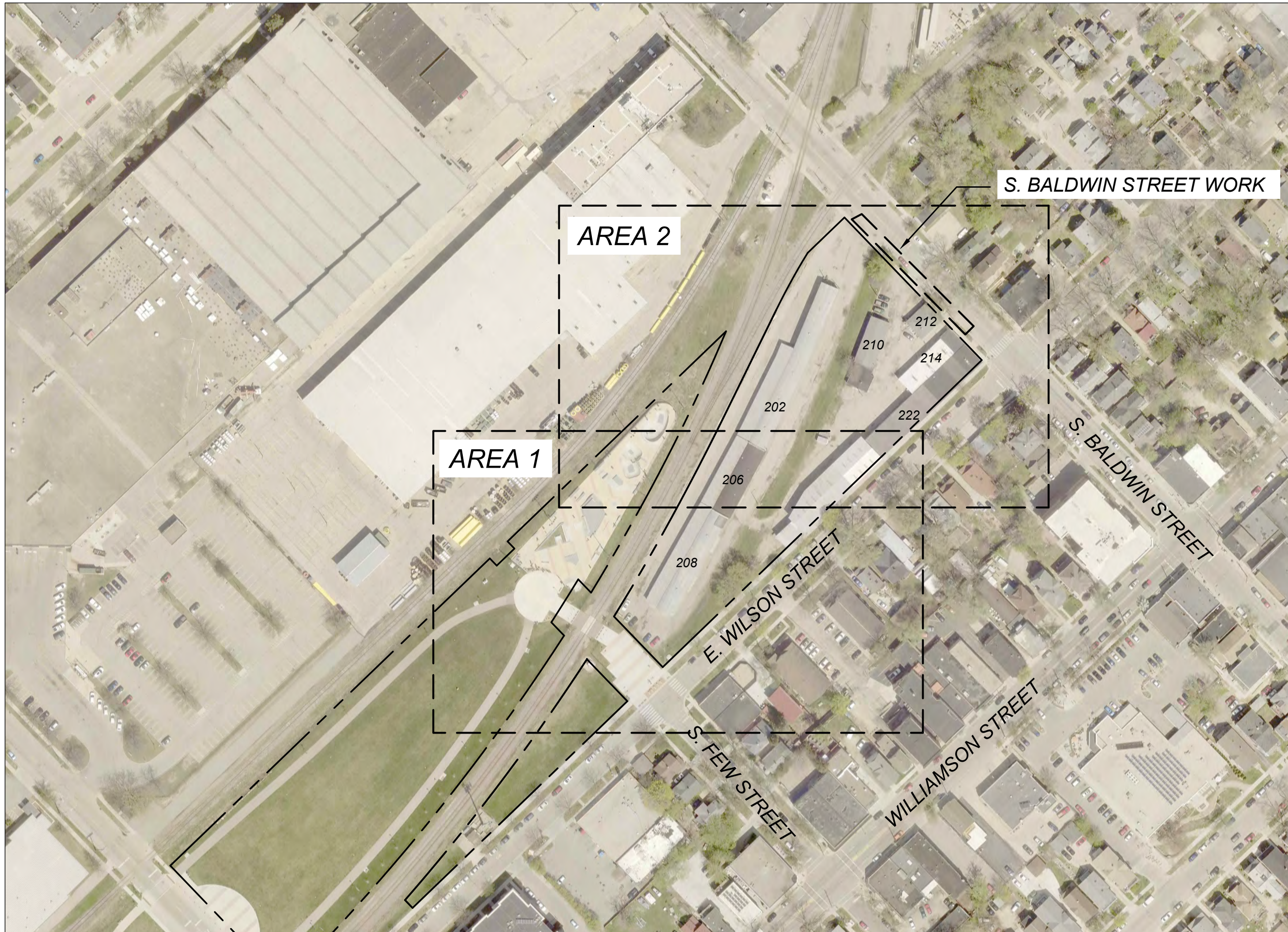

City of Madison  
 Department of Public Works  
**PARKS DIVISION**  
 330 E. Lakeside Street  
 Madison, WI 53715

*play*  
**MADISON  
 PARKS**

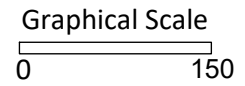

PROJECT:  
*McPIKE PARK  
 BUILDING  
 DEMOLITION AND  
 SITE RESTORATION*

PROJECT ADDRESS:  
*202-212 S. BALDWIN ST.  
 MADISON, WI 53703*

Although every effort has been made in preparing these plans and checking them for accuracy, the contractor and subcontractors must check all details and dimensions of their trade and be responsible for the same.

ITEM	DATE
BID RELEASE DATE	07-25-24

PUBLIC WORKS PROJECT #:  
*9174*

SHEET TITLE:  
*SHEET TILING*

SHEET NUMBER:  
**1.1**



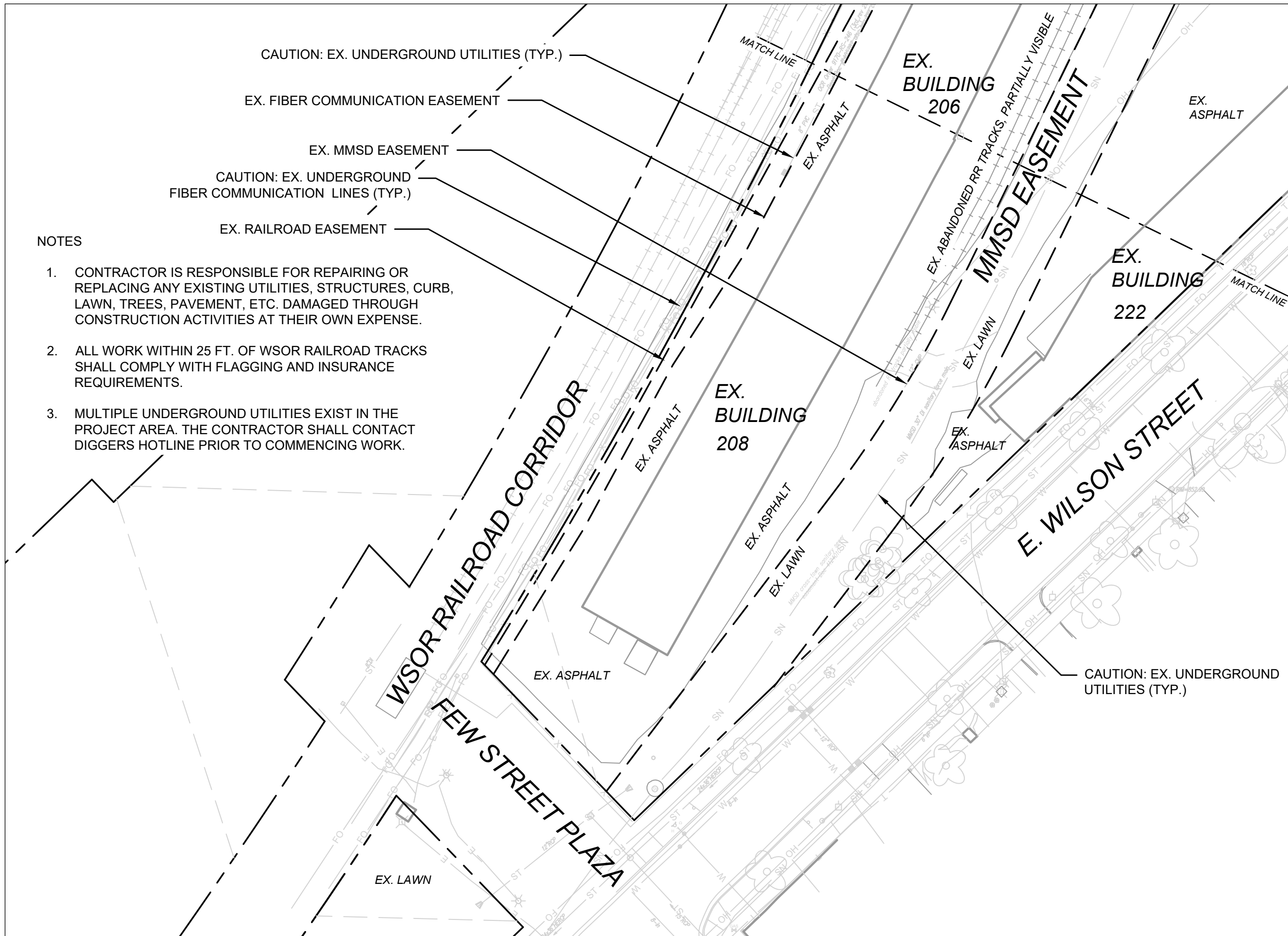

- NOTES
1. CONTRACTOR IS RESPONSIBLE FOR REPAIRING OR REPLACING ANY EXISTING UTILITIES, STRUCTURES, CURB, LAWN, TREES, PAVEMENT, ETC. DAMAGED THROUGH CONSTRUCTION ACTIVITIES AT THEIR OWN EXPENSE.
  2. ALL WORK WITHIN 25 FT. OF WSOR RAILROAD TRACKS SHALL COMPLY WITH FLAGGING AND INSURANCE REQUIREMENTS.
  3. MULTIPLE UNDERGROUND UTILITIES EXIST IN THE PROJECT AREA. THE CONTRACTOR SHALL CONTACT DIGGERS HOTLINE PRIOR TO COMMENCING WORK.

City of Madison  
 Department of Public Works  
**PARKS DIVISION**  
 330 E. Lakeside Street  
 Madison, WI 53715

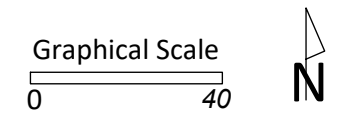

PROJECT:  
*McPIKE PARK  
 BUILDING  
 DEMOLITION AND  
 SITE RESTORATION*

PROJECT ADDRESS:  
*202-212 S. BALDWIN ST.  
 MADISON, WI 53703*

*Although every effort has been made in preparing these plans and checking them for accuracy, the contractor and subcontractors must check all details and dimensions of their trade and be responsible for the same.*

ITEM	DATE
BID RELEASE DATE	07-25-24

PUBLIC WORKS PROJECT #:  
*9174*

SHEET TITLE:  
*EXISTING SITE  
 CONDITIONS - AREA 1*

SHEET NUMBER:  
**1.2**

NOTES

1. CONTRACTOR IS RESPONSIBLE FOR REPAIRING OR REPLACING ANY EXISTING UTILITIES, STRUCTURES, CURB, LAWN, TREES, PAVEMENT, ETC. DAMAGED THROUGH CONSTRUCTION ACTIVITIES AT THEIR OWN EXPENSE.
2. ALL WORK WITHIN 25 FT. OF WSOR RAILROAD TRACKS SHALL COMPLY WITH FLAGGING AND INSURANCE REQUIREMENTS.
3. MULTIPLE UNDERGROUND UTILITIES EXIST IN THE PROJECT AREA. THE CONTRACTOR SHALL CONTACT DIGGERS HOTLINE PRIOR TO COMMENCING WORK.

CAUTION: EX. UNDERGROUND UTILITY (TYP.)

CAUTION: EX. UNDERGROUND FIBER COMMUNICATION LINES (TYP.)

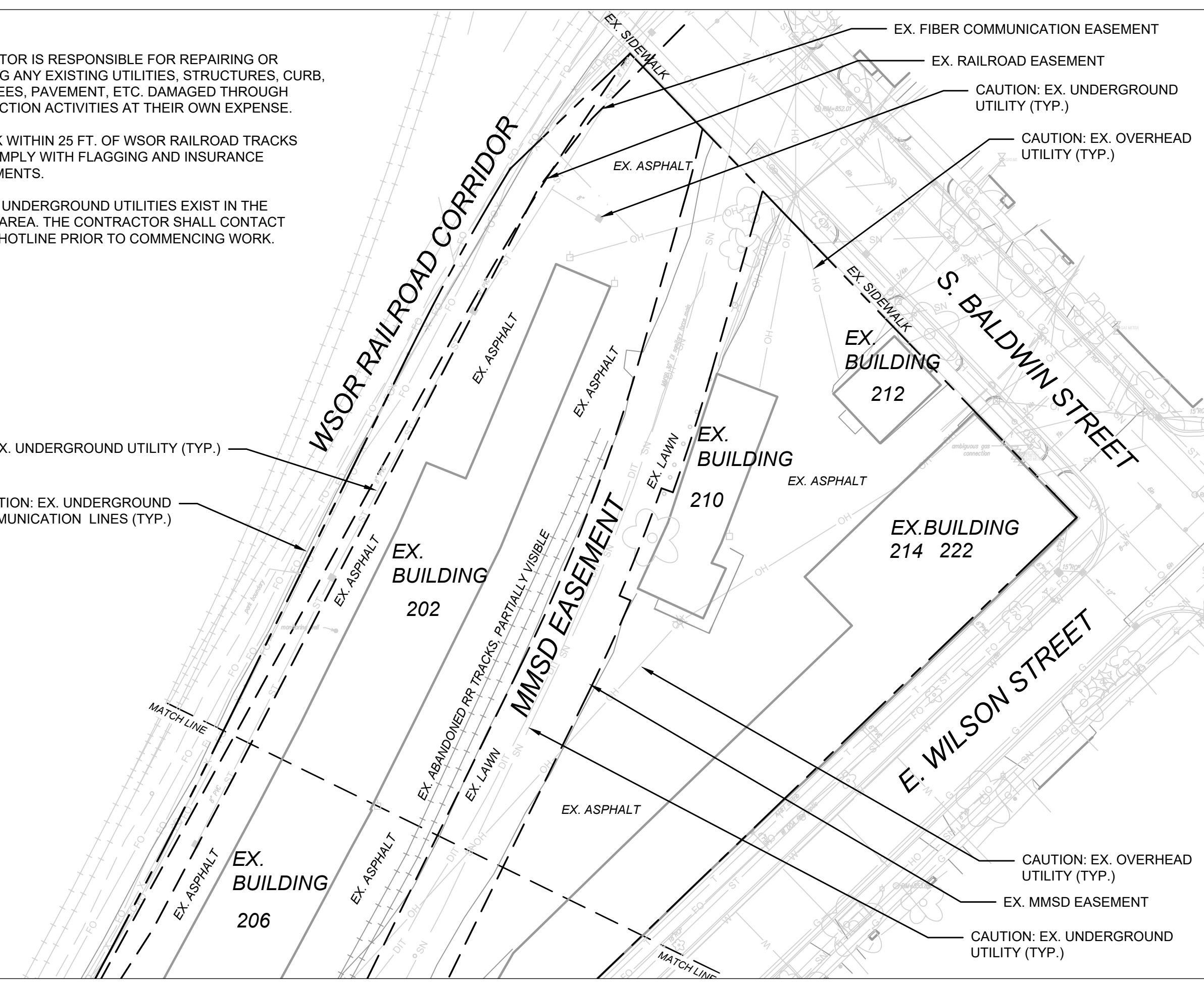

City of Madison  
 Department of Public Works  
**PARKS DIVISION**  
 330 E. Lakeside Street  
 Madison, WI 53715

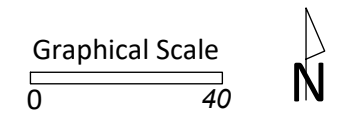

PROJECT:  
*McPIKE PARK  
 BUILDING  
 DEMOLITION AND  
 SITE RESTORATION*

PROJECT ADDRESS:  
*202-212 S. BALDWIN ST.  
 MADISON, WI 53703*

Although every effort has been made in preparing these plans and checking them for accuracy, the contractor and subcontractors must check all details and dimensions of their trade and be responsible for the same.

ITEM	DATE
BID RELEASE DATE	07-25-24

PUBLIC WORKS PROJECT #:  
*9174*

SHEET TITLE:  
*EXISTING SITE  
 CONDITIONS - AREA 2*





SHEET NUMBER:  
**1.3**



NOTES

1. CONTRACTOR IS RESPONSIBLE FOR REPAIRING OR REPLACING ANY EXISTING UTILITIES, STRUCTURES, CURB, LAWN, TREES, PAVEMENT, ETC. DAMAGED THROUGH CONSTRUCTION ACTIVITIES AT THEIR OWN EXPENSE.
2. ALL WORK WITHIN 25 FT. OF WSOR RAILROAD TRACKS SHALL COMPLY WITH FLAGGING AND INSURANCE REQUIREMENTS.
3. MULTIPLE UNDERGROUND UTILITIES EXIST IN THE PROJECT AREA. THE CONTRACTOR SHALL CONTACT DIGGERS HOTLINE PRIOR TO COMMENCING WORK.

LEGEND

-  EX. BUILDING DEMOLITIONS:  
202-208 S. BALDWIN ST.  
210 S. BALDWIN ST.  
212 S. BALDWIN ST.
-  EX. ASPHALT REMOVAL AND EXCAVATION
-  INLET PROTECTION, TYPE D, COMPLETE
-  SILT SOCK (8 - INCH COMPLETE)

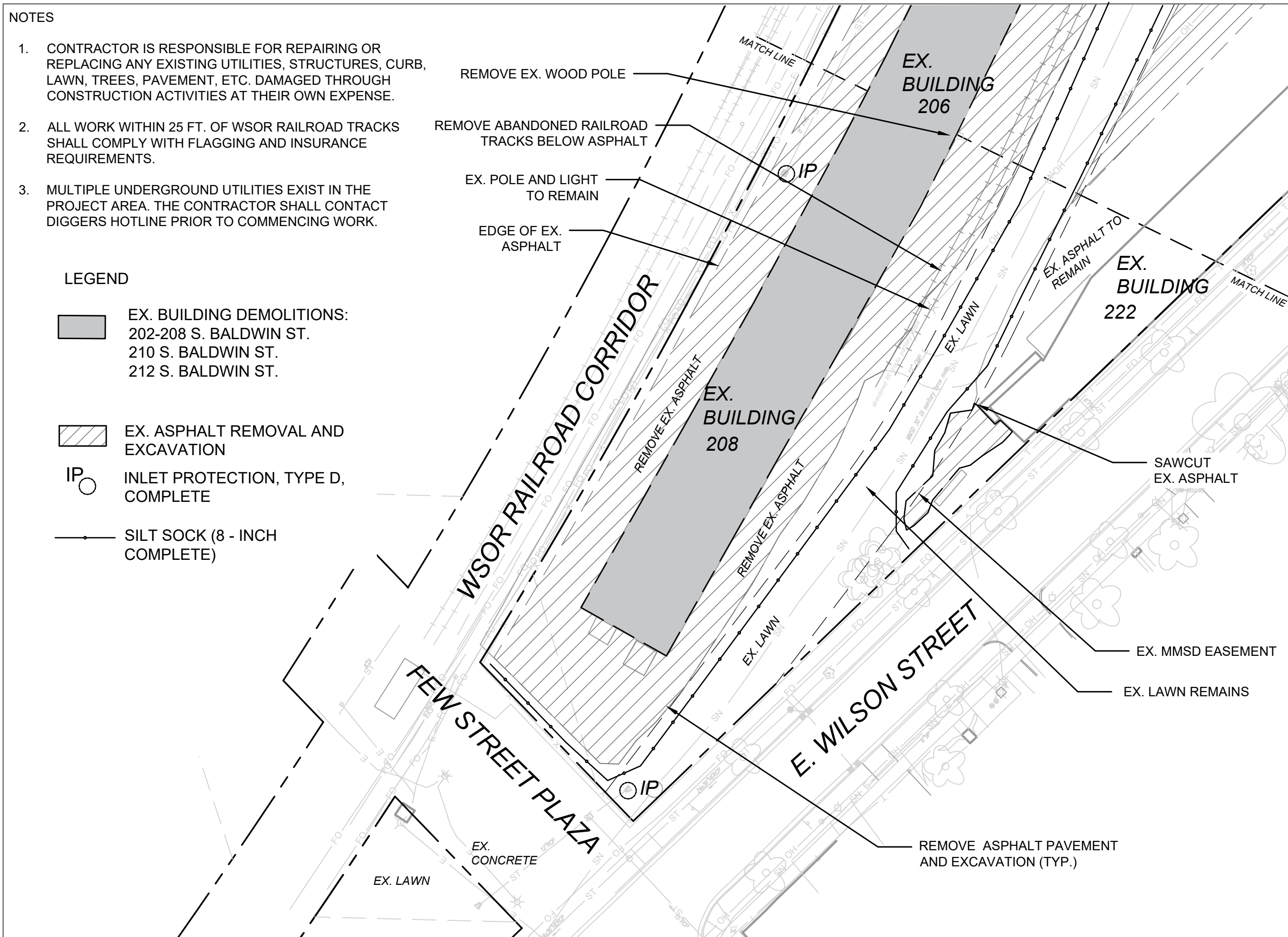

City of Madison  
Department of Public Works  
**PARKS DIVISION**  
330 E. Lakeside Street  
Madison, WI 53715

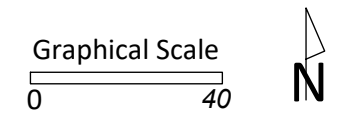

PROJECT:  
*McPIKE PARK BUILDING DEMOLITION AND SITE RESTORATION*

PROJECT ADDRESS:  
*202-212 S. BALDWIN ST.  
MADISON, WI 53703*

Although every effort has been made in preparing these plans and checking them for accuracy, the contractor and subcontractors must check all details and dimensions of their trade and be responsible for the same.

ITEM	DATE
BID RELEASE DATE	07-25-24

PUBLIC WORKS PROJECT #:  
*9174*





SHEET TITLE:  
*DEMOLITION AND SITE PROTECTION - AREA 1*

SHEET NUMBER:  
**2.1**

NOTES

1. CONTRACTOR IS RESPONSIBLE FOR REPAIRING OR REPLACING ANY EXISTING UTILITIES, STRUCTURES, CURB, LAWN, TREES, PAVEMENT, ETC. DAMAGED THROUGH CONSTRUCTION ACTIVITIES AT THEIR OWN EXPENSE.
2. ALL WORK WITHIN 25 FT. OF WSOR RAILROAD TRACKS SHALL COMPLY WITH FLAGGING AND INSURANCE REQUIREMENTS.
3. MULTIPLE UNDERGROUND UTILITIES EXIST IN THE PROJECT AREA. THE CONTRACTOR SHALL CONTACT DIGGERS HOTLINE PRIOR TO COMMENCING WORK.

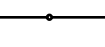
LEGEND

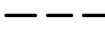
-  EX. BUILDING DEMOLITIONS:  
202-208 S. BALDWIN ST.  
210 S. BALDWIN ST.  
212 S. BALDWIN ST.
-  EX. ASPHALT REMOVAL AND EXCAVATION
-  INLET PROTECTION, TYPE D, COMPLETE
-  SILT SOCK (8 - INCH COMPLETE)
-  CONSTRUCTION ENTRANCE
-  SAW CUT EX. ASPHALT

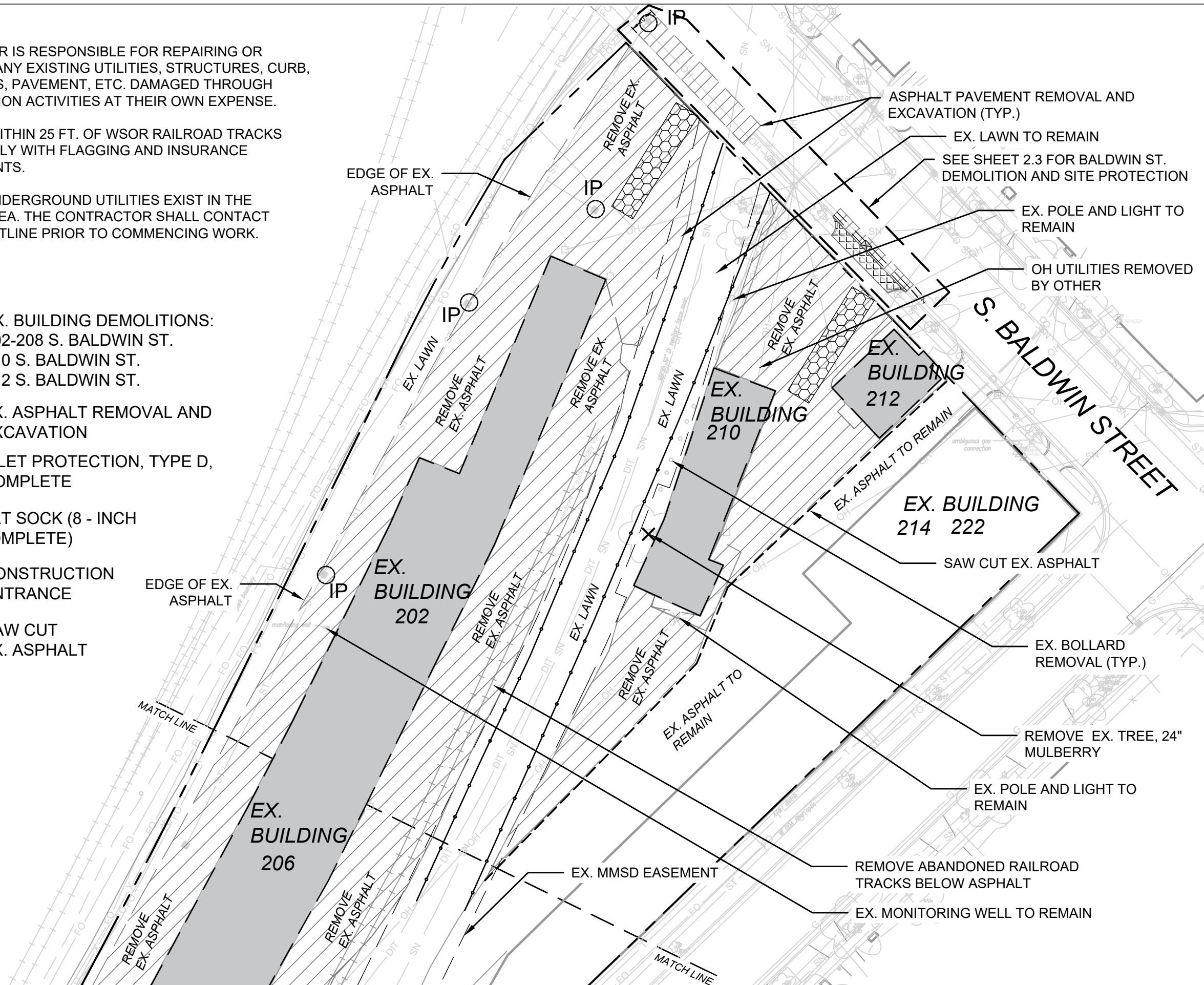

City of Madison  
Department of Public Works  
**PARKS DIVISION**  
330 E. Lakeside Street  
Madison, WI 53715

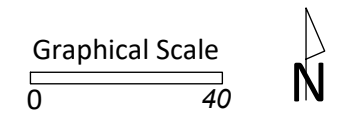

PROJECT:  
*McPIKE PARK BUILDING DEMOLITION AND SITE RESTORATION*

PROJECT ADDRESS:  
*202-212 S. BALDWIN ST.  
MADISON, WI 53703*

Although every effort has been made in preparing these plans and checking them for accuracy, the contractor and subcontractors must check all details and dimensions of their trade and be responsible for the same.

ITEM	DATE
BID RELEASE DATE	07-25-24



PUBLIC WORKS PROJECT #:  
*9174*

SHEET TITLE:  
*DEMOLITION AND SITE PROTECTION - AREA 2*

SHEET NUMBER:  
**2.2**

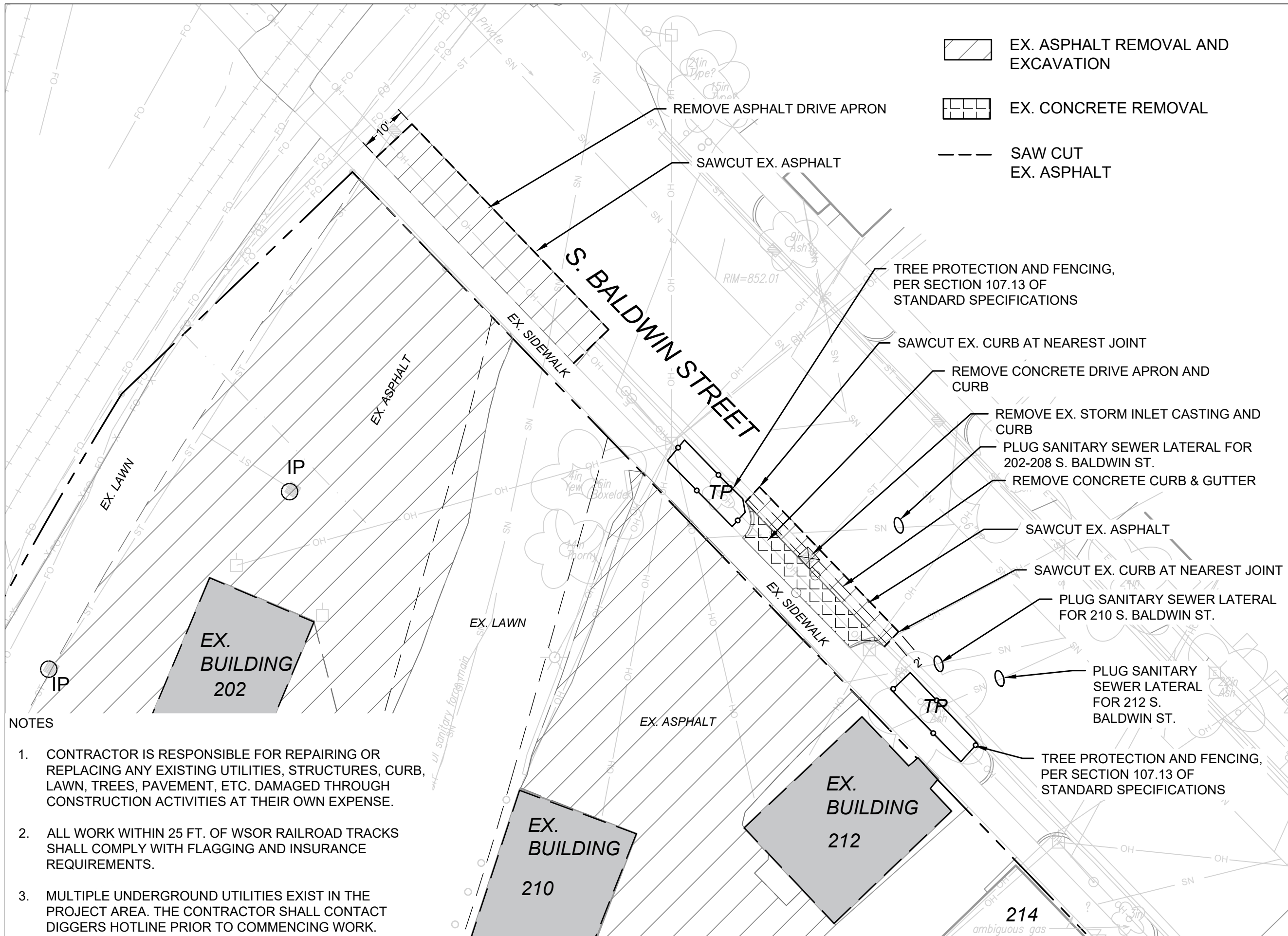

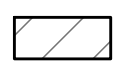
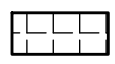

-  EX. ASPHALT REMOVAL AND EXCAVATION
-  EX. CONCRETE REMOVAL
-  SAW CUT EX. ASPHALT

City of Madison  
 Department of Public Works  
**PARKS DIVISION**  
 330 E. Lakeside Street  
 Madison, WI 53715

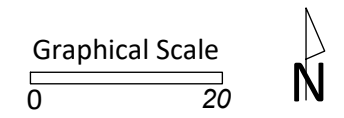

PROJECT:  
**McPIKE PARK BUILDING DEMOLITION AND SITE RESTORATION**

PROJECT ADDRESS:  
**202-212 S. BALDWIN ST. MADISON, WI 53703**

Although every effort has been made in preparing these plans and checking them for accuracy, the contractor and subcontractors must check all details and dimensions of their trade and be responsible for the same.

ITEM	DATE
BID RELEASE DATE	07-25-24

PUBLIC WORKS PROJECT #:  
**9174**

SHEET TITLE:  
**DEMOLITION AND SITE PROTECTION - BALDWIN STREET**

SHEET NUMBER:  
**2.3**

- NOTES
1. CONTRACTOR IS RESPONSIBLE FOR REPAIRING OR REPLACING ANY EXISTING UTILITIES, STRUCTURES, CURB, LAWN, TREES, PAVEMENT, ETC. DAMAGED THROUGH CONSTRUCTION ACTIVITIES AT THEIR OWN EXPENSE.
  2. ALL WORK WITHIN 25 FT. OF WSOR RAILROAD TRACKS SHALL COMPLY WITH FLAGGING AND INSURANCE REQUIREMENTS.
  3. MULTIPLE UNDERGROUND UTILITIES EXIST IN THE PROJECT AREA. THE CONTRACTOR SHALL CONTACT DIGGERS HOTLINE PRIOR TO COMMENCING WORK.



NOTES

- 1. CONTRACTOR IS RESPONSIBLE FOR REPAIRING OR REPLACING ANY EXISTING UTILITIES, STRUCTURES, CURB, LAWN, TREES, PAVEMENT, ETC. DAMAGED THROUGH CONSTRUCTION ACTIVITIES AT THEIR OWN EXPENSE.
- 2. ALL WORK WITHIN 25 FT. OF WSOR RAILROAD TRACKS SHALL COMPLY WITH FLAGGING AND INSURANCE REQUIREMENTS.
- 3. MULTIPLE UNDERGROUND UTILITIES EXIST IN THE PROJECT AREA. THE CONTRACTOR SHALL CONTACT DIGGERS HOTLINE PRIOR TO COMMENCING WORK.

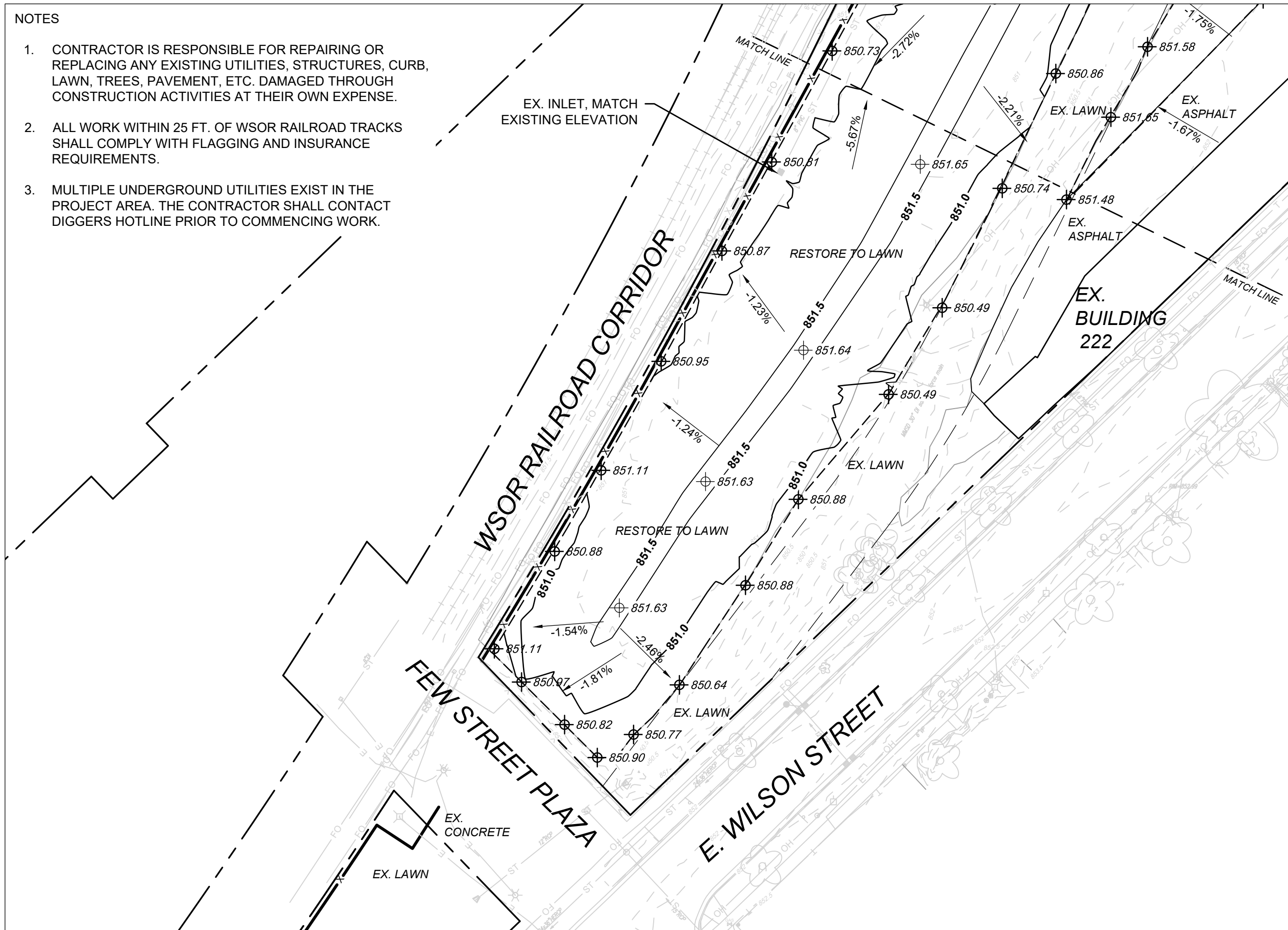

City of Madison  
 Department of Public Works  
**PARKS DIVISION**  
 330 E. Lakeside Street  
 Madison, WI 53715

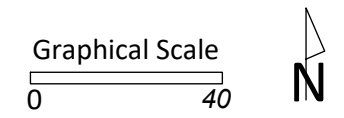

PROJECT:  
**McPIKE PARK  
 BUILDING  
 DEMOLITION AND  
 SITE RESTORATION**

PROJECT ADDRESS:  
**202-212 S. BALDWIN ST.  
 MADISON, WI 53703**

Although every effort has been made in preparing these plans and checking them for accuracy, the contractor and subcontractors must check all details and dimensions of their trade and be responsible for the same.

ITEM	DATE
BID RELEASE DATE	07-25-24

PUBLIC WORKS PROJECT #:  
**9174**

SHEET TITLE:  
**SITE GRADING - AREA 1**

SHEET NUMBER:  
**3.1**



NOTES

1. CONTRACTOR IS RESPONSIBLE FOR REPAIRING OR REPLACING ANY EXISTING UTILITIES, STRUCTURES, CURB, LAWN, TREES, PAVEMENT, ETC. DAMAGED THROUGH CONSTRUCTION ACTIVITIES AT THEIR OWN EXPENSE.
2. ALL WORK WITHIN 25 FT. OF WSOR RAILROAD TRACKS SHALL COMPLY WITH FLAGGING AND INSURANCE REQUIREMENTS.
3. MULTIPLE UNDERGROUND UTILITIES EXIST IN THE PROJECT AREA. THE CONTRACTOR SHALL CONTACT DIGGERS HOTLINE PRIOR TO COMMENCING WORK.

City of Madison  
 Department of Public Works  
**PARKS DIVISION**  
 330 E. Lakeside Street  
 Madison, WI 53715

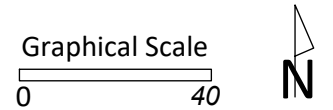

PROJECT:  
*McPIKE PARK  
 BUILDING  
 DEMOLITION AND  
 SITE RESTORATION*

PROJECT ADDRESS:  
*202-212 S. BALDWIN ST.  
 MADISON, WI 53703*

*Although every effort has been made in preparing these plans and checking them for accuracy, the contractor and subcontractors must check all details and dimensions of their trade and be responsible for the same.*

ITEM	DATE
BID RELEASE DATE	07-25-24

PUBLIC WORKS PROJECT #:  
*9174*

SHEET TITLE:  
*SITE GRADING - AREA 2*

SHEET NUMBER:  
**3.2**

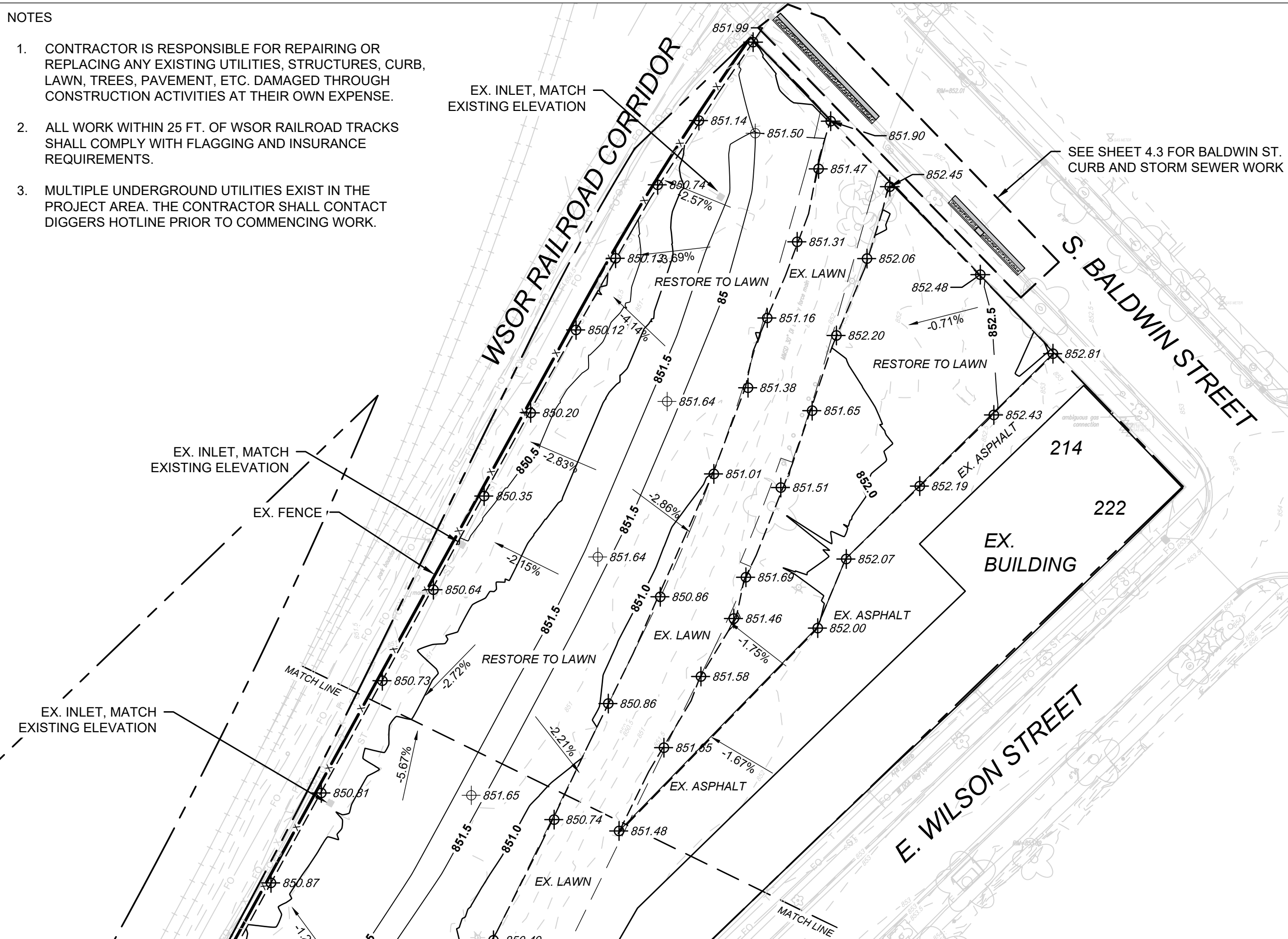



NOTES

1. CONTRACTOR IS RESPONSIBLE FOR REPAIRING OR REPLACING ANY EXISTING UTILITIES, STRUCTURES, CURB, LAWN, TREES, PAVEMENT, ETC. DAMAGED THROUGH CONSTRUCTION ACTIVITIES AT THEIR OWN EXPENSE.
2. ALL WORK WITHIN 25 FT. OF WSOR RAILROAD TRACKS SHALL COMPLY WITH FLAGGING AND INSURANCE REQUIREMENTS.
3. MULTIPLE UNDERGROUND UTILITIES EXIST IN THE PROJECT AREA. THE CONTRACTOR SHALL CONTACT DIGGERS HOTLINE PRIOR TO COMMENCING WORK.

LEGEND

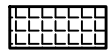

SITE RESTORATION AREA: INCLUDES PLACEMENT OF 6-INCHES OF CLEAN FILL, 6-INCHES TOPSOIL, SEEDING AND EROSION MAT

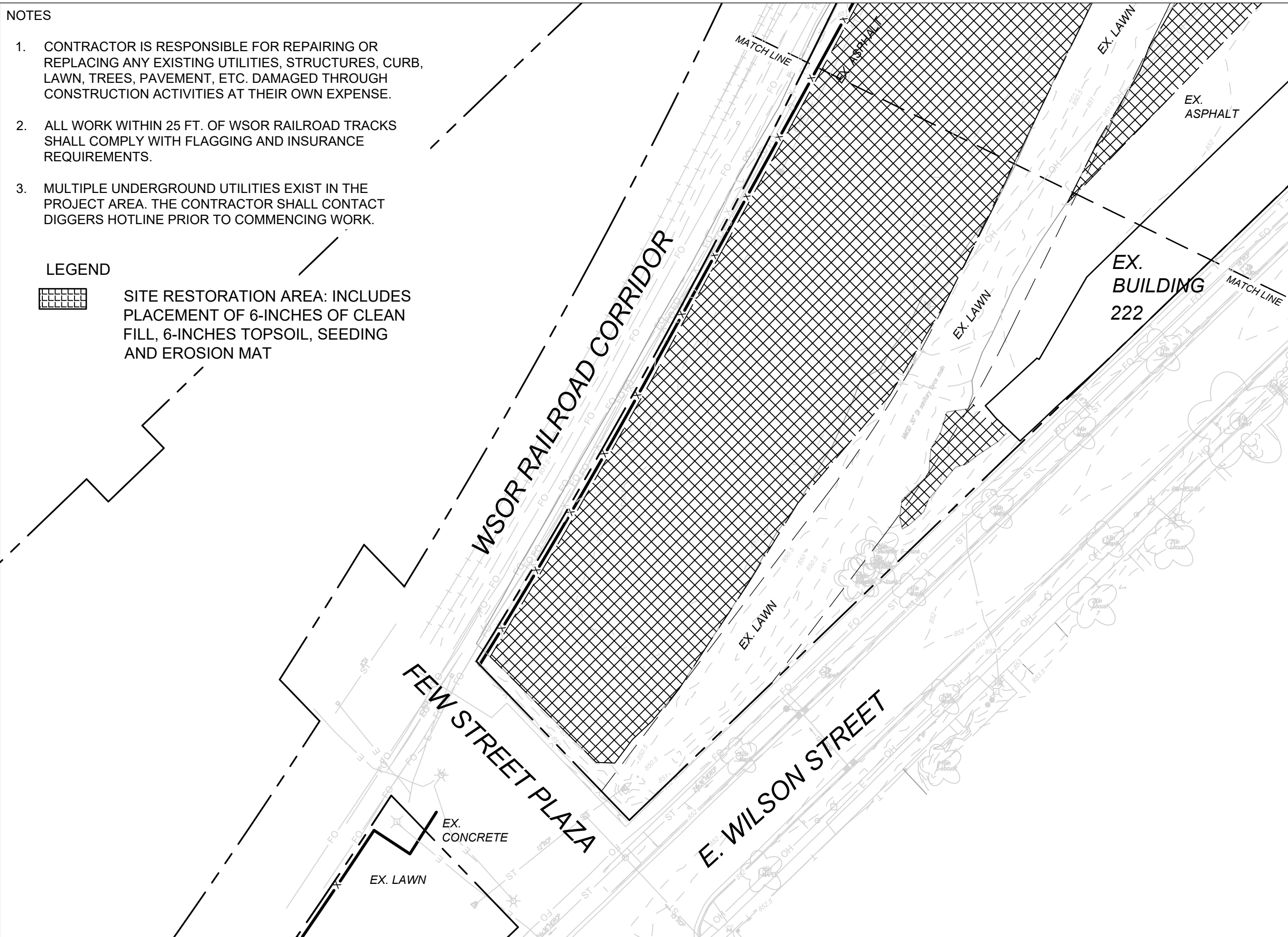

City of Madison  
 Department of Public Works  
**PARKS DIVISION**  
 330 E. Lakeside Street  
 Madison, WI 53715



Graphical Scale

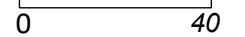

PROJECT:

*McPIKE PARK  
 BUILDING  
 DEMOLITION AND  
 SITE RESTORATION*

PROJECT ADDRESS:

*202-212 S. BALDWIN ST.  
 MADISON, WI 53703*

Although every effort has been made in preparing these plans and checking them for accuracy, the contractor and subcontractors must check all details and dimensions of their trade and be responsible for the same.

ITEM	DATE
BID RELEASE DATE	07-25-24

PUBLIC WORKS PROJECT #:  
**9174**

SHEET TITLE:  
*SITE RESTORATION -  
 AREA 1*

SHEET NUMBER:  
**4.1**



**NOTES**

1. CONTRACTOR IS RESPONSIBLE FOR REPAIRING OR REPLACING ANY EXISTING UTILITIES, STRUCTURES, CURB, LAWN, TREES, PAVEMENT, ETC. DAMAGED THROUGH CONSTRUCTION ACTIVITIES AT THEIR OWN EXPENSE.
2. ALL WORK WITHIN 25 FT. OF WSOR RAILROAD TRACKS SHALL COMPLY WITH FLAGGING AND INSURANCE REQUIREMENTS.
3. MULTIPLE UNDERGROUND UTILITIES EXIST IN THE PROJECT AREA. THE CONTRACTOR SHALL CONTACT DIGGERS HOTLINE PRIOR TO COMMENCING WORK.

**LEGEND**

 SITE RESTORATION AREA: INCLUDES PLACEMENT OF 6-INCHES OF CLEAN FILL, 6-INCHES TOPSOIL, SEEDING AND EROSION MAT

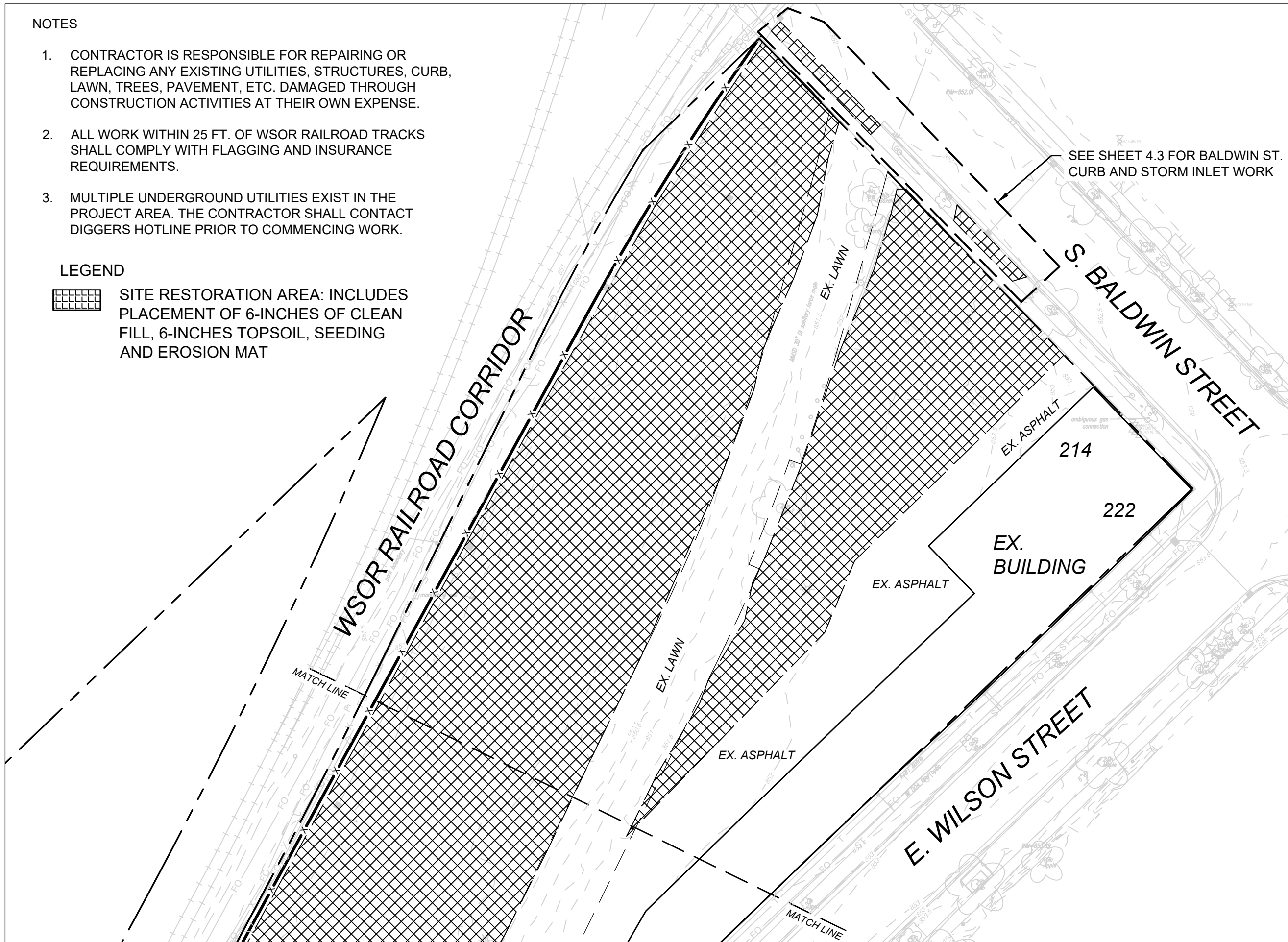

City of Madison  
 Department of Public Works  
**PARKS DIVISION**  
 330 E. Lakeside Street  
 Madison, WI 53715

**play  
 MADISON  
 PARKS**

Graphical Scale

0 40



PROJECT:

*McPIKE PARK  
 BUILDING  
 DEMOLITION AND  
 SITE RESTORATION*

PROJECT ADDRESS:

*202-212 S. BALDWIN ST.  
 MADISON, WI 53703*

Although every effort has been made in preparing these plans and checking them for accuracy, the contractor and subcontractors must check all details and dimensions of their trade and be responsible for the same.

ITEM	DATE
BID RELEASE DATE	07-25-24

PUBLIC WORKS PROJECT #:  
*9174*

SHEET TITLE:  
*SITE RESTORATION -  
 AREA 2*

SHEET NUMBER:  
**4.2**



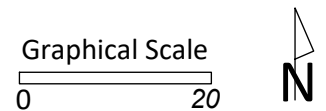

PROJECT:  
**McPIKE PARK  
 BUILDING  
 DEMOLITION AND  
 SITE RESTORATION**

PROJECT ADDRESS:  
**202-212 S. BALDWIN ST.  
 MADISON, WI 53703**

Although every effort has been made in preparing these plans and checking them for accuracy, the contractor and subcontractors must check all details and dimensions of their trade and be responsible for the same.

ITEM	DATE
BID RELEASE DATE	07-25-24

PUBLIC WORKS PROJECT #:  
**9174**

SHEET TITLE:  
**SITE RESTORATION -  
 BALDWIN STREET**

SHEET NUMBER:  
**4.3**

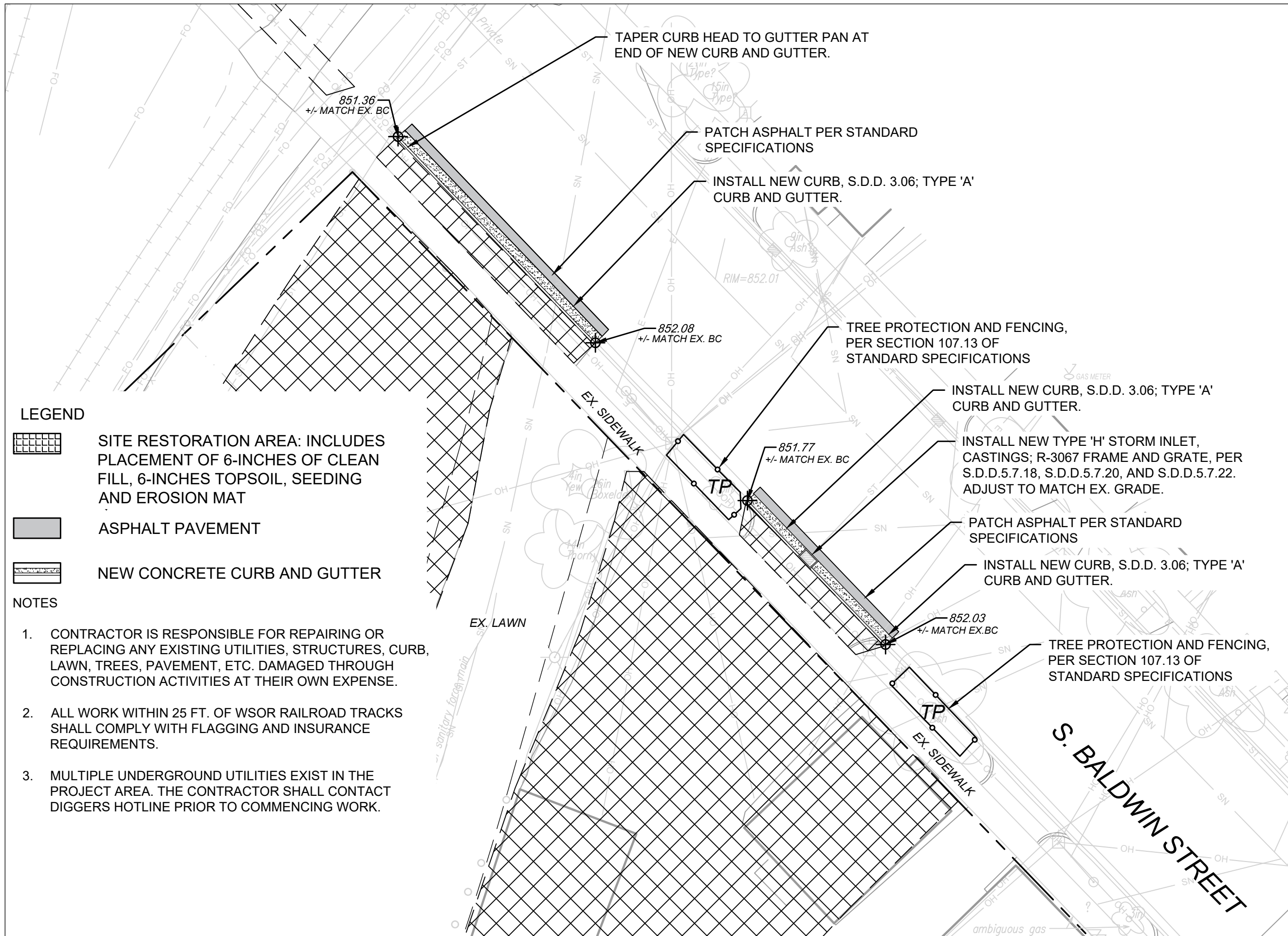

**LEGEND**

- SITE RESTORATION AREA: INCLUDES PLACEMENT OF 6-INCHES OF CLEAN FILL, 6-INCHES TOPSOIL, SEEDING AND EROSION MAT
- ASPHALT PAVEMENT
- NEW CONCRETE CURB AND GUTTER

**NOTES**

1. CONTRACTOR IS RESPONSIBLE FOR REPAIRING OR REPLACING ANY EXISTING UTILITIES, STRUCTURES, CURB, LAWN, TREES, PAVEMENT, ETC. DAMAGED THROUGH CONSTRUCTION ACTIVITIES AT THEIR OWN EXPENSE.
2. ALL WORK WITHIN 25 FT. OF WSOR RAILROAD TRACKS SHALL COMPLY WITH FLAGGING AND INSURANCE REQUIREMENTS.
3. MULTIPLE UNDERGROUND UTILITIES EXIST IN THE PROJECT AREA. THE CONTRACTOR SHALL CONTACT DIGGERS HOTLINE PRIOR TO COMMENCING WORK.





**202-208 S. BALDWIN ST. EXTERIOR**

City of Madison  
 Department of Public Works  
**PARKS DIVISION**  
 330 E. Lakeside Street  
 Madison, WI 53715

**play**  
**MADISON**  
**PARKS**

PROJECT:  
*McPIKE PARK  
 BUILDING  
 DEMOLITION AND  
 SITE RESTORATION*

PROJECT ADDRESS:  
*202-212 S. BALDWIN ST.  
 MADISON, WI 53703*

Although every effort has been made in preparing these plans and checking them for accuracy, the contractor and subcontractors must check all details and dimensions of their trade and be responsible for the same.

ITEM	DATE
BID RELEASE DATE	07-25-24

PUBLIC WORKS PROJECT #:  
*9174*

SHEET TITLE:  
*BUILDING PHOTOS*

SHEET NUMBER:  
**5.1**





City of Madison  
 Department of Public Works  
**PARKS DIVISION**  
 330 E. Lakeside Street  
 Madison, WI 53715

*play*  
**MADISON  
 PARKS**

PROJECT:  
*McPIKE PARK  
 BUILDING  
 DEMOLITION AND  
 SITE RESTORATION*

PROJECT ADDRESS:  
*202-212 S. BALDWIN ST.  
 MADISON, WI 53703*

Although every effort has been made in preparing these plans and checking them for accuracy, the contractor and subcontractors must check all details and dimensions of their trade and be responsible for the same.

ITEM	DATE
BID RELEASE DATE	07-25-24

PUBLIC WORKS PROJECT #:  
*9174*

SHEET TITLE:  
*BUILDING PHOTOS*

SHEET NUMBER:  
**5.2**

**202-208 S. BALDWIN ST. INTERIOR**





City of Madison  
 Department of Public Works  
**PARKS DIVISION**  
 330 E. Lakeside Street  
 Madison, WI 53715

**play**  
**MADISON**  
**PARKS**

PROJECT:  
*McPIKE PARK  
 BUILDING  
 DEMOLITION AND  
 SITE RESTORATION*

PROJECT ADDRESS:  
*202-212 S. BALDWIN ST.  
 MADISON, WI 53703*

Although every effort has been made in preparing these plans and checking them for accuracy, the contractor and subcontractors must check all details and dimensions of their trade and be responsible for the same.

ITEM	DATE
BID RELEASE DATE	07-25-24

PUBLIC WORKS PROJECT #:  
*9174*

SHEET TITLE:  
*BUILDING PHOTOS*

SHEET NUMBER:  
**5.3**

**210 S. BALDWIN ST. EXTERIOR**





City of Madison  
 Department of Public Works  
**PARKS DIVISION**  
 330 E. Lakeside Street  
 Madison, WI 53715

**play**  
**MADISON**  
**PARKS**

PROJECT:  
*McPIKE PARK  
 BUILDING  
 DEMOLITION AND  
 SITE RESTORATION*

PROJECT ADDRESS:  
*202-212 S. BALDWIN ST.  
 MADISON, WI 53703*

Although every effort has been made in preparing these plans and checking them for accuracy, the contractor and subcontractors must check all details and dimensions of their trade and be responsible for the same.

ITEM	DATE
BID RELEASE DATE	07-25-24

PUBLIC WORKS PROJECT #:  
*9174*

SHEET TITLE:  
*BUILDING PHOTOS*

SHEET NUMBER:  
**5.4**

**210 S. BALDWIN ST. INTERIOR**





City of Madison  
 Department of Public Works  
**PARKS DIVISION**  
 330 E. Lakeside Street  
 Madison, WI 53715

*play*  
**MADISON  
 PARKS**

PROJECT:  
*McPIKE PARK  
 BUILDING  
 DEMOLITION AND  
 SITE RESTORATION*

PROJECT ADDRESS:  
*202-212 S. BALDWIN ST.  
 MADISON, WI 53703*

Although every effort has been made in preparing these plans and checking them for accuracy, the contractor and subcontractors must check all details and dimensions of their trade and be responsible for the same.

ITEM	DATE
BID RELEASE DATE	07-25-24

PUBLIC WORKS PROJECT #:  
*9174*

SHEET TITLE:  
*BUILDING PHOTOS*

SHEET NUMBER:  
**5.5**

**212 S. BALDWIN ST. EXTERIOR**



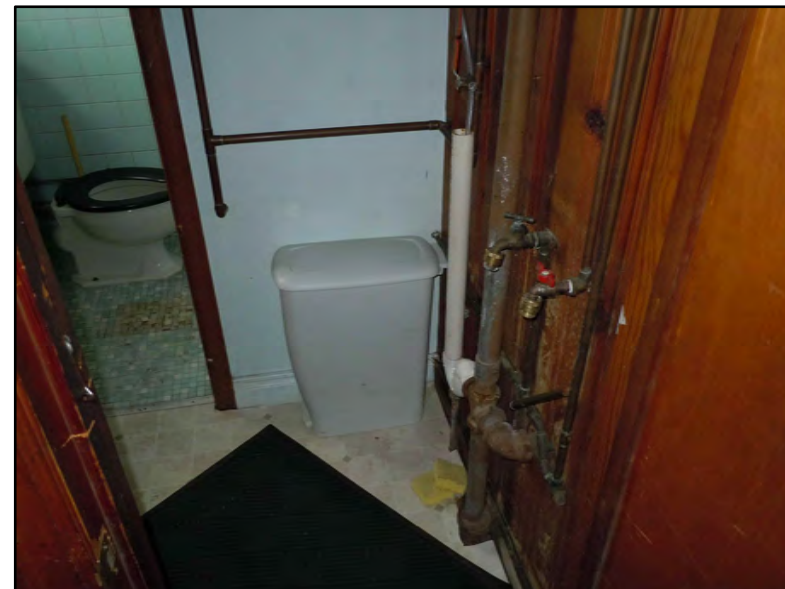

City of Madison  
 Department of Public Works  
**PARKS DIVISION**  
 330 E. Lakeside Street  
 Madison, WI 53715

**play**  
**MADISON**  
**PARKS**

PROJECT:  
*McPIKE PARK  
 BUILDING  
 DEMOLITION AND  
 SITE RESTORATION*

PROJECT ADDRESS:  
*202-212 S. BALDWIN ST.  
 MADISON, WI 53703*

Although every effort has been made in preparing these plans and checking them for accuracy, the contractor and subcontractors must check all details and dimensions of their trade and be responsible for the same.

ITEM	DATE
BID RELEASE DATE	07-25-24

PUBLIC WORKS PROJECT #:  
*9174*

SHEET TITLE:  
*BUILDING PHOTOS*

SHEET NUMBER:  
**5.6**

## 212 S. BALDWIN ST. INTERIOR



**McPike Park Building Demolition - Earthwork Quantities**

City of Madison, WI Public Works Contract  
Date Revised: 5/20/2024

**Notes:**  
Cuts are positive volumes, fills are negative volumes.  
Not all parts of all surface models (Digital Terrain Models) are used for computations or intended for actual construction.

Existing  
Proposed  
Proposed

North Section				From Surface Model	To Surface Model	area (sq ft)	depth (ft)	Unfac-tored volume (cu ft)	Unfac-tored volume (cu yd)	Expans-ion Factor (%)	Factored (Uncom-pacted) Volume (cu yd)
Sort	Grp	Material	Item								
	Railroad Tracks to Grass	Asphalt Excavate	Remove existing asphalt surface, estimated depth 3 inch	n/a	n/a	2801	0.25	650	24.1	0%	24.1
	Railroad Tracks to Grass	RR track removal	Remove existing rr tracks surface, estimated depth 18	n/a	n/a	2601	1.50	3902	144.5	0%	144.5
	Railroad Tracks to Grass	Subsoil Place	Fill subsoil to proposed subgrade	Ex-21in	Pro-6in	2601	varies	3515	130.2	0%	130.2
	Railroad Tracks to Grass	Topsoil Place	Place 6in topsoil	n/a	n/a	2601	-0.50	-1301	-48.2	0%	-48.2
	Building to Grass	Building Excavate	Excavate 12in building slab	n/a	n/a	18709	1.00	18709	692.9	0%	692.9
	Building to Grass	Subsoil Excavate	Cut subsoil to proposed subgrade	Ex-12in	Pro-6in	18709	varies	0	0.0	0%	0.0
	Building to Grass	Subsoil Place	Fill subsoil to proposed subgrade	Ex-12in	Pro-6in	18709	varies	-12915	-478.3	0%	-478.3
	Building to Grass	Topsoil Place	Place 6in topsoil	n/a	n/a	18709	-0.50	-9355	-346.5	0%	-346.5
	Asphalt to Grass	Asphalt Excavate	Remove existing asphalt, estimated depth 9in	n/a	n/a	28005	0.75	21004	777.9	0%	777.9
	Asphalt to Grass	Subsoil Excavate	Cut subsoil to proposed subgrade	Ex-9in	Pro-12in	28005	varies	4174	154.6	0%	154.6
	Asphalt to Grass	Subsoil Place	Fill subsoil to proposed subgrade	Ex-9in	Pro-12in	28005	varies	-1109	-41.1	0%	-41.1
	Asphalt to Grass	Subsoil Place	Place 6in subsoil	n/a	n/a	28005	0.50	14003	518.6	0%	518.6
	Asphalt to Grass	Topsoil Place	Place 6in topsoil	n/a	n/a	28005	-0.50	-14003	-518.6	0%	-518.6

-263

South Section				From Surface Model	To Surface Model	area (sq ft)	depth (ft)	Unfac-tored volume (cu ft)	Unfac-tored volume (cu yd)	Expans-ion Factor (%)	Factored (Uncom-pacted) Volume (cu yd)
Sort	Grp	Material	Item								
210	Building to Grass	Building Excavate	Excavate 12in building slab	n/a	n/a	2614	1.00	2614	96.8	0%	96.8
210	Building to Grass	Subsoil Excavate	Cut subsoil to proposed subgrade	Ex-12in	Pro-6in	2614	varies	1	0.1	0%	0.1
210	Building to Grass	Subsoil Place	Fill subsoil to proposed subgrade	Ex-12in	Pro-6in	2614	varies	1058	39.2	0%	39.2
210	Building to Grass	Topsoil Place	Place 6in topsoil	n/a	n/a	2614	-0.50	-1307	-48.4	0%	-48.4
	Asphalt to Grass	Asphalt Excavate	Remove existing asphalt, estimated depth 9in	n/a	n/a	8246	0.75	6184	229.1	0%	229.1
	Asphalt to Grass	Subsoil Excavate	Cut subsoil to proposed subgrade	Ex-9in	Pro-12in	8246	varies	1656	61.3	0%	61.3
	Asphalt to Grass	Subsoil Place	Fill subsoil to proposed subgrade	Ex-9in	Pro-12in	8246	varies	-84	-3.1	0%	-3.1
	Asphalt to Grass	Subsoil Place	Place 6in subsoil	n/a	n/a	8246	-0.50	-4123	-152.7	0%	-152.7
	Asphalt to Grass	Topsoil Place	Place 6in topsoil	n/a	n/a	8246	0.50	4123	152.7	0%	152.7
	Building to Grass	Building Excavate	Excavate 12in building slab	n/a	n/a	959	1.00	959	35.5	0%	35.5
	Building to Grass	Subsoil Excavate	Cut subsoil to proposed subgrade	Ex-12in	Pro-6in	959	varies	5	0.2	0%	0.2
	Building to Grass	Subsoil Place	Fill subsoil to proposed subgrade	Ex-12in	Pro-6in	959	varies	391	14.5	0%	14.5
	Building to Grass	Topsoil Place	Place 6in topsoil	n/a	n/a	959	-0.50	-479	-17.8	0%	-17.8

**McPike Park Building Demolitions - Earthwork Quantities**

City of Madison, WI Public Works Contract  
Date Revised: 5/20/2024

Derived from more detailed spreadsheet available from Parks Div

**Computation Summary**

Positive volumes are cuts (material available), negative volumes are fills (material needed)

**Row Labels**    **Sum of Unfac-tored volume (cu yd)**

Subsoil Excavate	216.1	Estimated offsite disposal per Bid Item 90003
Subsoil Place	-1377.7	
Topsoil Place	-1132.1	
Asphalt Excavate	1031.1	
RR track removal	144.5	
Building Excavate	825.3	
<b>Grand Total</b>	<b>-292.8</b>	

Bid Item	Quantity	Units		Relation to Table Above
		CY		
20101 Excavation Cut	2072	CY		=Subsoil Excavate + Asphalt Excavate + Building Excavate
20202 Fill Borrow	1378	CY		= Subsoil Place
20221 Topsoil	6779	SY		= Topsoil Place

City of Madison  
Department of Public Works  
**PARKS DIVISION**  
330 E. Lakeside Street  
Madison, WI 53715



PROJECT:  
**McPIKE PARK BUILDING DEMOLITION AND SITE RESTORATION**

PROJECT ADDRESS:  
**202-212 S. BALDWIN ST. MADISON, WI 53703**

*Although every effort has been made in preparing these plans and checking them for accuracy, the contractor and subcontractors must check all details and dimensions of their trade and be responsible for the same.*

ITEM DATE  
BID RELEASE DATE 07-25-24

PUBLIC WORKS PROJECT #:  
**9174**

SHEET TITLE:  
**EARTHWORK COMPUTATIONS**

SHEET NUMBER:  
**6.1**